

ELEVATION "B" - "B"

ITEM	MANUFACTURER	MODEL	DESCRIPTION	EXIST	PRPD	FUT.
1	SPEED QUEEN	SWTB61	18 LB. WASHER/EXTRACTOR	14	2	
2	SPEED QUEEN	SC25	25 LB. WASHER/EXTRACTOR	8	4	
3	SPEED QUEEN	SC40	40 LB. WASHER/EXTRACTOR	4	4	
4	SPEED QUEEN	SC60	60 LB. WASHER/EXTRACTOR	2	4	
5	SPEED QUEEN	SC80	80 LB. WASHER/EXTRACTOR	2	2	
6	SPEED QUEEN	STT45	45 LB. STACK TUMBLER	14	4	
7	SPEED QUEEN	ST075	75 LB. TUMBLER	5	3	
8	ROWE	BC2800	BILL CHANGER	1	1	
9	VENDRITE	894	8 COLLUMN SOAP VENDER	1	1	
10	HAMILTON	HW599	HOT WATER HEATER	1	1	
11	HAMILTON	HE775	HOT WATER TANK	1	1	

EQUIPMENT LIST

GAS REQUIREMENTS				
MODEL	GAS TYPE	MAX INPUT BTU/HOUR	CONNECTION SIZE	RECOMMENDED SUPPLY LINE
STT45	NATURAL	190,000	1/2"	TO BE DETERMINED BY GENERAL CONTRACTOR
ST075	NATURAL	165,000	1/2"	
HW599	NATURAL	630,000	1"	

ELECTRICAL REQUIREMENTS				
MODEL	VOLTAGE	PHASE	CIRCUIT BREAKER	WIRE SIZE
SWTB61	120	60	1	15 AMP
SC25	208-240	60	3	15 AMP
SC40	208-240	60	3	20 AMP
SC60	208-240	60	3	20 AMP
SC80	208-240	60	3	20 AMP
STT45	208-240	60	1	15 AMP
ST075	120	60	1	20 AMP
CARD	120	60	1	15 AMP
HW599	208-240	60	1	*3 AMPS

CONSULT ELECTRICAL CODE FOR LOCAL REQUIREMENTS. MANUFACTURERS' RECOMMENDATIONS SHOULD BE PROVIDED FOR EACH MACHINE. \*MAXIMUM AMPERAGE DRAW AT 230 VOLTS AND ONE PHASE IS LESS THAN 3 AMPS.

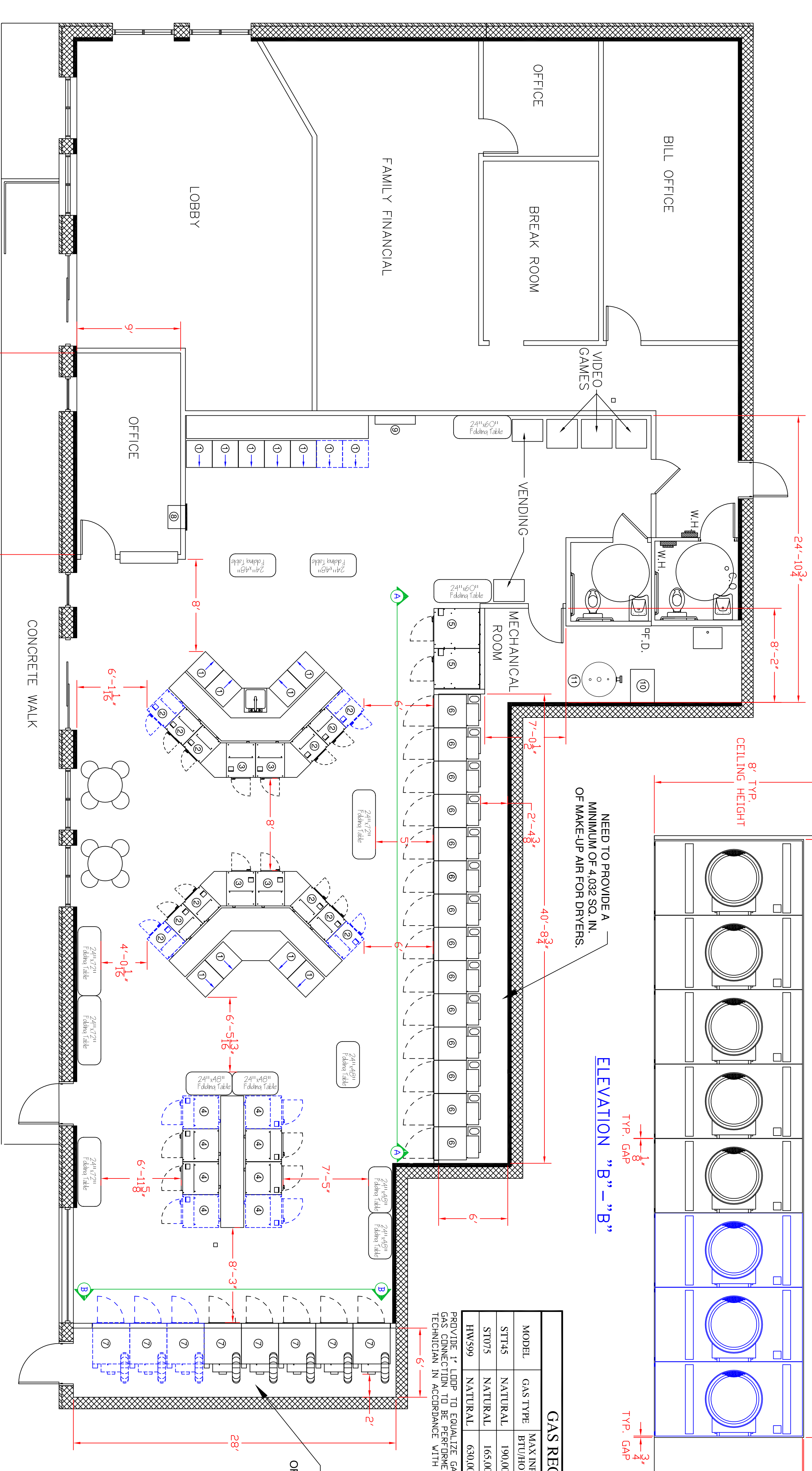

NEED TO PROVIDE A MINIMUM OF 1,560 SQ. IN. OF MAKE-UP AIR FOR DRYERS.

WATER REQUIREMENTS			
MODEL	COLD CONN. SIZE	HOT CONN. SIZE	RECOMMENDED LINE SIZE TO SUPPLY ALL MACHINES
SWTB61	3/4"	3/4"	TO BE DETERMINED BY GENERAL CONTRACTOR
SC25	3/4"	3/4"	
SC40	3/4"	3/4"	
SC60	3/4"	3/4"	
SC80	3/4"	3/4"	
HW599	1-1/2"	-	-

EXHAUST / FRESH AIR MAKE-UP REQ.

MODEL	EXHAUST SIZE	AIR FLOW	FRESH AIR MAKE-UP REQUIREMENTS
STT45	10"	1,200 CFM ea.	Total Dryers 4,032 SQ. IN.
ST075	8"	900 CFM ea.	Total Dryers 1,560 SQ. IN.
HW599	5"	-	DIRECT VENT

WHEN JOINING EXHAUST VENTS TO PLUMBS, USE 45° ANGLES. DUCTWORK SIZE WILL VARY WITH INSTALLATION CONDITIONS. EXHAUST STATIC PRESSURE SHOULD NOT EXCEED 0.3 INCHES (0.74mcld) WATER COLUMN.

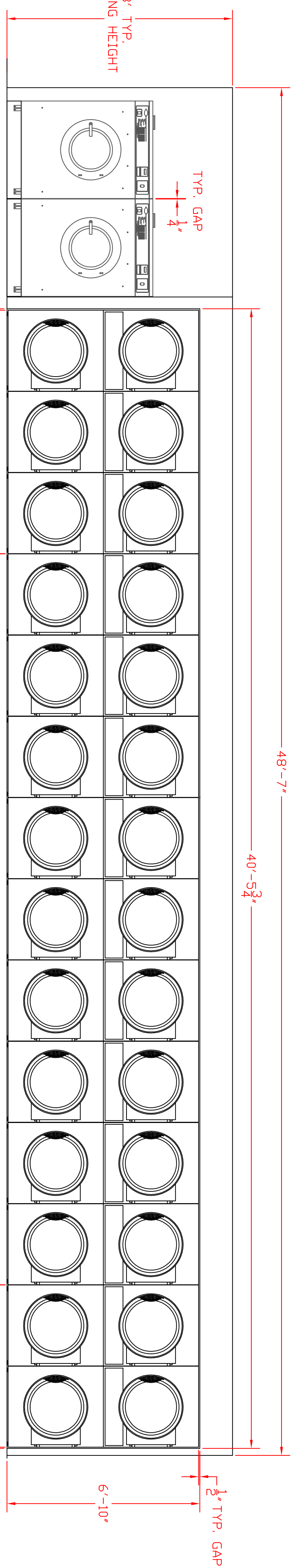

ELEVATION "A" - "A"

NOTE: 1. ELEVATIONS ARE NOT TO SCALE.

BY: \_\_\_\_\_ DATE: \_\_\_\_\_ DRAWING APPROVED

**PAC** Industries, Incorporated  
 5341 Jaycoe Ave. Harrisburg, Pa 17112  
 Phone: (717) 657-0407 (800) 692-6214 Fax: (717) 657-9678

COIN LAUNDRY LAYOUT

REV. 2	SCALE: 3/16" = 1'	DATE:	DRAWING # LA206029
DRAWING 1 OF 1			NAME: SMITH

This drawing is the sole property of PAC Industries and has been created based on preliminary information supplied by others. Strictly provided without the express knowledge and consent of PAC Industries and must be returned on demand. This drawing is not to be used for any other project without the express written permission of PAC Industries. Any action that may prove detrimental to PAC Industries is strictly prohibited.